

# 飞智八爪鱼4 力反馈精英手柄

APEX 4 Elite Gaming Controller

用户手册  
User Manual



扫码查看完整版用户手册  
扫描下方二维码查看用户手册  
Scan QR code to read the user manual  
QR 코드를 스캔하시면 사용설명서를 보실 수 있습니다

## 摇杆力调节使用说明

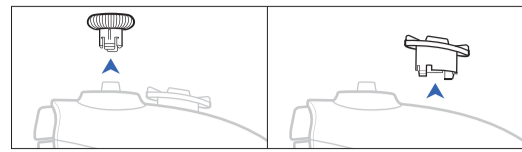

1 垂直向上拔掉摇杆帽,并取下十字键

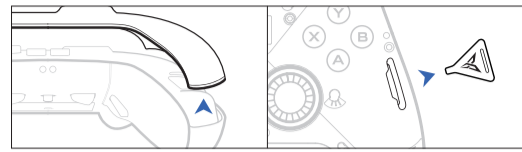

2 沿握把缝隙处取下磁吸外壳,从手柄右侧取出力调节拨片

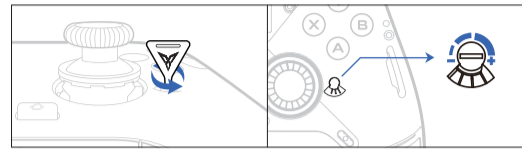

3 通过拨片旋转摇杆右侧的螺丝,调节摇杆力度;可通过螺帽边缘与刻度的相切位置,记忆当前摇杆的力度;调节过程可装上摇杆帽,方便实时感受摇杆力度

## 力反馈扳机使用说明

### 自适应模式

根据游戏实时场景变化,自动切换扳机的力反馈手感。  
请用电脑访问 [www.flydigi.com](http://www.flydigi.com) 下载「飞智空间站」,开启自适应模式。

### 自定义模式

模式	介绍
常规	无力反馈效果,常规的线性扳机
赛车	仿真踩油门的阻尼感
狙击	仿真枪械段落式扳机手感
机枪	仿真连发射击的高频后坐力
震动	跟随握把同步震动,提升沉浸感
扳机锁	调节扳机的触发行程

### 飞智空间站 开启更多自定义

访问飞智官网 [www.flydigi.com](http://www.flydigi.com) 下载「飞智空间站」,可自定义按键、宏、体感、扳机等功能。



## 连接手柄

将手柄背部开关拨到 ON, 长按  $\triangle$  键打开屏幕菜单, 可设置手柄模式、按键配置等功能

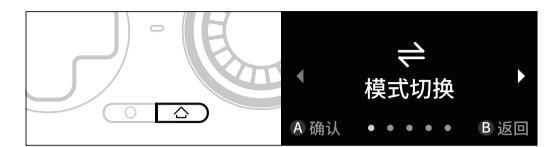

## 连接电脑

打开屏幕菜单, 选择【模式切换】-[PC], 通过接收器或数据线连接电脑和手柄



一段时间不使用, 手柄将自动休眠, 按  $\triangle$  键即可唤醒手柄, 可在飞智空间站修改进入休眠的时间。

## 连接 Switch

将手柄切换到 Switch 模式, 点击 Switch 首页的手柄图标, 进入【更改握法/顺序】, 手柄将自动配对连接



### Switch 模式下按键和键值映射关系如下

A	B	X	Y	SELECT	START	$\triangle$	$\circ$
B	A	Y	X	.	+	主页	截图

## 连接安卓/iOS设备

- 1 扫描二维码, 下载安装飞智游戏厅APP
- 2 进入飞智游戏厅-外设管理, 点击添加设备, 按照游戏厅内引导进行手柄连接



## 规格

平台	模式	连接方式	系统要求
PC	XInput/DInput	接收器/有线/蓝牙	Win 7 及以上
Switch	Switch	蓝牙	Switch
Android	DInput/Flashplay	蓝牙	安卓10及以上
iOS	iOS	蓝牙	iOS14及以上

XInput 模式: 适用于绝大多数原生支持手柄的游戏  
DInput 模式: 适用于原生支持手柄的模拟器游戏  
Flashplay 模式: 适用于不支持手柄的手机游戏, 需配合飞智游戏厅使用

无线射频: 蓝牙 5.0 蓝牙 5.0 BLE  
使用距离: 小于10米  
电池信息: 可充电锂离子电芯, 电池容量1500mAh, 充电时间3-4小时, 充电电压5V, 充电电流1000mA  
工作电流: 使用时电流小于80mA (不含马达和力反馈扳机), 待机时电流小于0.1mA  
温度范围: -10°C~50°C 下使用和存放

## 外观

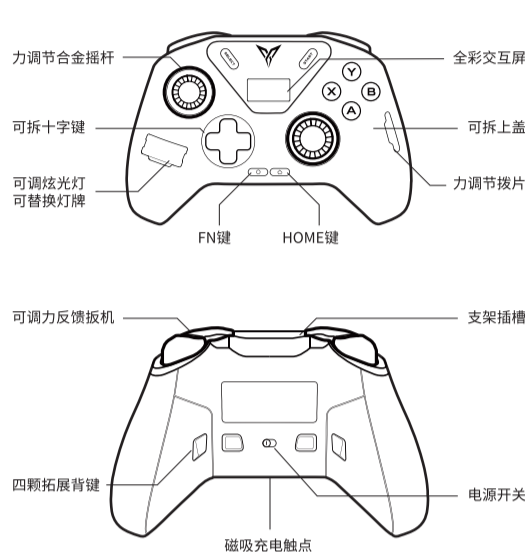

## 常见问题

- Q: 手柄蓝牙无法连接?  
A: 在屏幕菜单-模式切换中, 点击重新配对, 此时手柄显示配对中, 打开设备蓝牙重新连接
- Q: 接收器连接信号不稳定 (延迟/断连等)?  
A: 如果周围存在较多的2.4G信号, 可能会产生干扰, 建议在接收器和电脑之间增加一根USB延长线, 起到增强信号的作用
- Q: 扳机/扳机/体感出现异常?  
A: 在电脑上安装飞智空间站, 进入测试页面, 按引导校准手柄

## 产品中有毒物质的名称及含量

部件名称	有害物质					
	铅 (Pb)	汞 (Hg)	镉 (Cd)	六价铬 (Cr (VI))	多溴联苯 (PBB)	多溴二苯醚 (PBDE)
印刷电路板组件	○	○	○	○	○	○
外壳	○	○	○	○	○	○
包装	○	○	○	○	○	○
线材	○	○	○	○	○	○
聚合物电池	○	○	○	○	○	○
硅胶	○	○	○	○	○	○
金属、胶甲、微小结构件	○	○	○	○	○	○

本表格依据 SJ/T 11364 的规定编制

- 表示该有害物质在该部件所有均质材料中的含量均在 GB/T 26572-2011 规定的限量要求以下
- × 表示该有害物质至少在该部件的某一均质材料中的含量超出 GB/T 26572-2011 规定的限量要求

# Flydigi APEX 4 Elite Gaming Controller

User Manual



Scan QR code to read the user manual

## Force Adjustable Joystick Instruction

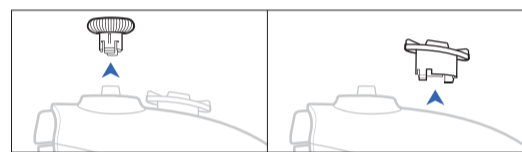

1 Remove the joystick cap by pulling it upwards vertically and take off the D-pad.



2 Remove the magnetic cover from the gap of the grip, and take out the force adjustment paddle from the right side of the controller.

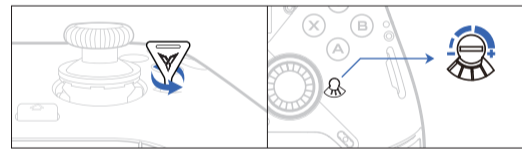

3 Adjust the joystick sensitivity by rotating the screw on the right side of the joystick using the adjustment paddle. You can use the tangent position between the edge of the screw and the scale as a reference to remember the current sensitivity of the joystick. Once the adjustment is complete, you can put the joystick cap back on to conveniently experience the sensitivity in real-time.

## Force Feedback Trigger Instruction

### Adaptive Mode

According to the real-time changes in the game scene, the force feedback sensation of the triggers is automatically switched. Please access [www.flydigi.com](http://www.flydigi.com) on your computer and download "Flydigi Space Station" to enable adaptive mode.

### Custom mode

Mode	Introduction
Regular	Force feedback function disabled, regular linear triggers
Race	Simulate the damping sensation when pressing the throttle
Sniper	Simulate the sensation of pressing the trigger on a sniper rifle
Recoil	Simulate the continuous oscillation of the trigger when firing a machine gun in sustained automatic fire
vibration	Simultaneously vibrate with the grip to enhance immersion
trigger lock	Adjust the trigger travel

### Open Flydigi Space Station For More Customize Setting

Visit our official website [www.flydigi.com](http://www.flydigi.com) to download "Flydigi Space Station". You can customize buttons, macros, motion sensing, joystick and other functions.

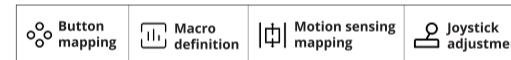

## Connect Your Controller

Pull the reel switch of the controller to ON, then short press the  $\triangle$  to open the menu on the screen, where you can configure the controller mode and button settings.



## Connect to a PC

Open the on-screen menu, select [Connect]-[PC], and connect the computer and the controller using a receiver or a cable/Home Capture

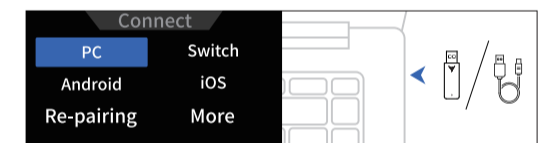

If the controller is not used for a period of time, it will automatically enter sleep mode. Press the  $\triangle$  to wake up the controller. You can modify the sleep timeout in the Flydigi Space Station.

## Connect to a Switch

Adjust the controller to Switch mode, click on the controllers icon on the home page of your Nintendo Switch, and go to [Change Grip/Order]. The controller will automatically pair and connect.

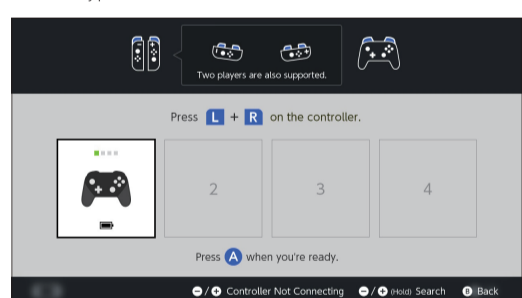

### At Switch mode, the button-to-key mapping is as follows

A	B	X	Y	SELECT	START	$\triangle$	$\circ$
B	A	Y	X	.	+	Home	Screenshot

## Connect to an Android/iOS device

1. Scan the QR code to download and install the Flydigi Game Hall app.
2. Enter Flydigi Game Hall - Peripheral Management and click on "Add Device". Follow the instructions provided in the game hall to connect the controller.



## specifications

Platform	Mode	Connection method	System Requirement
PC	XInput/DInput	Dongle/Cable/ BT	Win 7 and above
Switch	Switch	BT	Switch
Android	DInput/Flashplay	BT	Android 10 and above
iOS	iOS	BT	iOS 14 and above

Xinput Mode: This mode is suitable for games that natively support controllers.  
Dinput Mode: This mode is suitable for emulator games that natively support controllers.  
Flashplay mode: This mode is suitable for mobile games that do not support controllers. It requires the use of the Flydigi Game Hall app as a companion.

Wireless RF: BT 5.0, BT 5.0 BLE  
Operating Distance: Less than 10 meters  
Battery Information: Rechargeable lithium-ion battery, battery capacity 1500mAh, charging time 3-4 hours, charging voltage 5V, charging current 1000mA  
Operating Current: Current less than 80mA during use (excluding motors and force feedback triggers), current less than 0.1mA in standby mode  
Temperature Range: Use and store between -10°C and 50°C

## Appearance

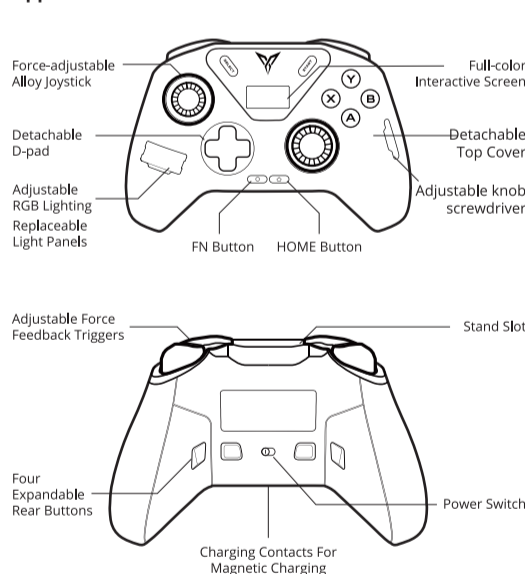

## FAQ

- Q: The controller BT cannot connect?  
A: In the screen menu - Connect, click Re-pairing. The controller will display "Pairing" at this time. Open the device's BT settings and reconnect.
- Q: Dongle connection signal is unstable. (delay/disconnect etc)  
A: If there are many 2.4GHz signals in the vicinity, it may cause interference. It is recommended to use a USB extension cable between the dongle and the computer to enhance the signal.
- Q: Joystick/trigger/motion sensor has anomalies?  
A: Install the Flydigi Space Station on your computer, enter the test page, and follow the instructions to calibrate the controller.

## The name and content of harmful substances in the product

Part Name	Toxic or Hazardous Substances and Elements					
	Pb	Hg	Cd	Cr	PBB	PBDE
PCB Board	○	○	○	○	○	○
Shell	○	○	○	○	○	○
Packaging	○	○	○	○	○	○
Wire	○	○	○	○	○	○
Polymer battery	○	○	○	○	○	○
Silicone	○	○	○	○	○	○
Small structural parts such as metal and tape	○	○	○	○	○	○

This form has been prepared in accordance with the provisions of SJ/T 11364

- Indicates that the content of the hazardous substance in all homogeneous materials of this part is within the limit specified in GB/T 26572-2011. Require the following
- × Indicates that the content of the hazardous substance in at least one homogeneous material of the component exceeds the provisions of GB/T 26572-2011. The limited requirements

70g双胶纸双面打印